

Thank you for purchasing a

HANSEN
Leveller Valve

Instructions for **NEW** INSTALLATIONS

Pack Includes:

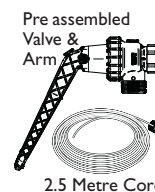

Blue Float



HiViz
Weighted Ball

32mm, 40mm,
50mm Adaptors

2.5 Metre Cord

Turn
Over For
EXISTING
INSTALLATIONS

IMPORTANT: Before connecting Leveller Valve to water system ensure lines are flushed and free of debris.

Step 1

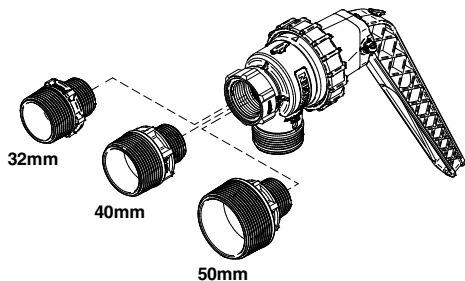

Determine adaptor thread size required for your installation.

Step 2

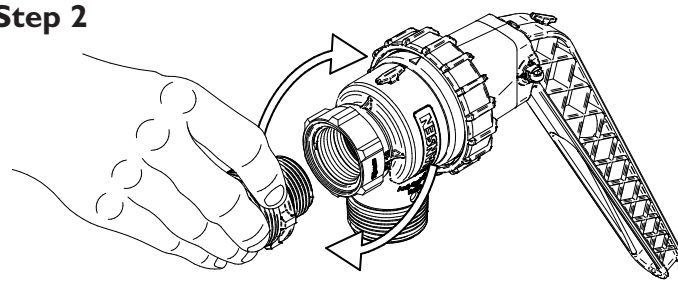

Screw selected adaptor into Leveller Valve Body (O-Ring facing to body)

Step 3a

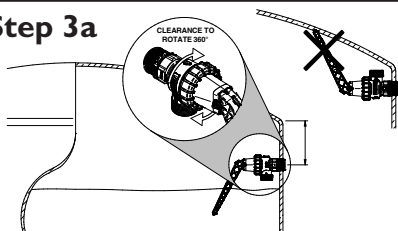

Ensure Tank Fitting location has enough clearance so valve can be rotated 360°. If use of tanks full height is required, refer to steps 3 & 4 on reverse for valve reassembly, then return here.

Step 3b

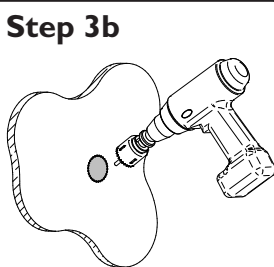

Cut required hole in tank.

Step 4

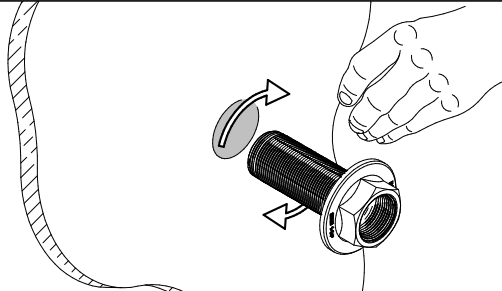

Install tank fitting (refer to tank fitting installation instructions).

Step 5a

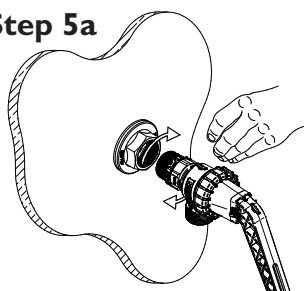

Screw Leveller Valve into tank fitting.

Step 5b

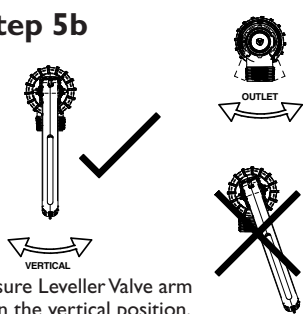

Ensure Leveller Valve arm is in the vertical position.

Step 6

Decide on water levels for **Minimum & Maximum**. See step 9 for minimum level guidance before proceeding through this step.

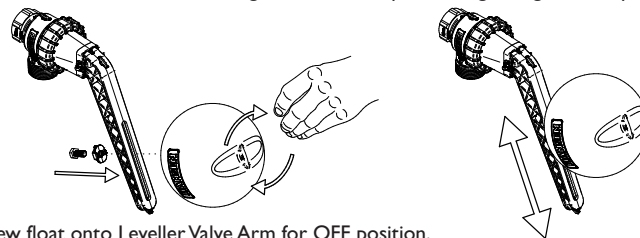

Screw float onto Leveller Valve Arm for OFF position. **This determines Maximum level of water.**

Step 7a

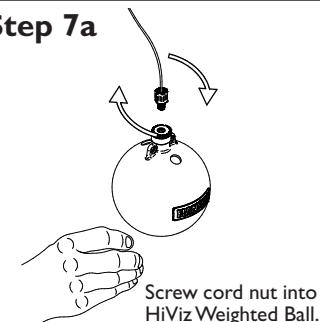

Screw cord nut into HiViz Weighted Ball.

Step 7b

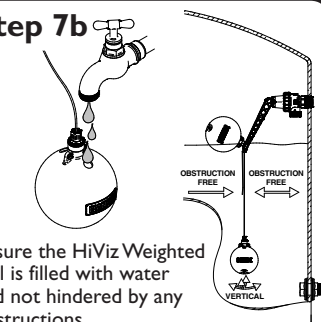

Ensure the HiViz Weighted Ball is filled with water and not hindered by any obstructions.

Step 8a

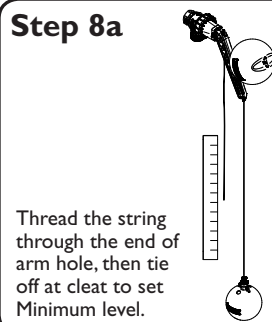

Thread the string through the end of arm hole, then tie off at cleat to set Minimum level.

Step 8b

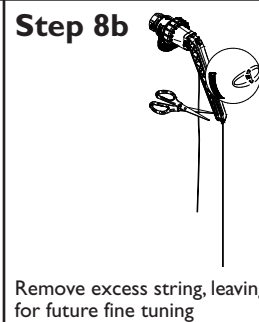

Remove excess string, leaving enough for future fine tuning

Step 9

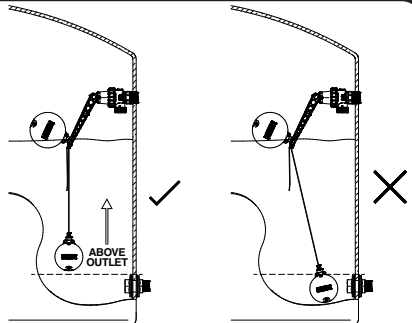

NOTE: The HiViz Weighted Ball must be off the bottom of the tank and most importantly above tank outlet.

Step 10a

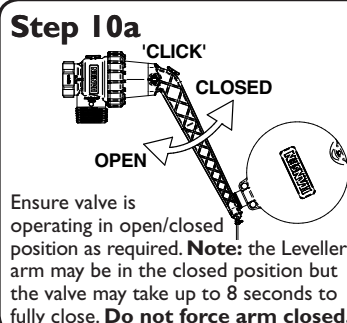

Ensure valve is operating in open/closed position as required. **Note:** the Leveller arm may be in the closed position but the valve may take up to 8 seconds to fully close. **Do not force arm closed.**

Step 10b

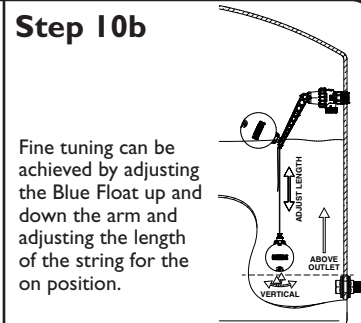

Fine tuning can be achieved by adjusting the Blue Float up and down the arm and adjusting the length of the string for the on position.

Thank you for purchasing a

HANSEN
Leveller Valve

Instructions for EXISTING INSTALLATIONS

Pack Includes:

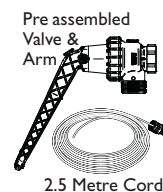

Blue Float



Turn Over For
NEW
INSTALLATIONS

IMPORTANT: Before connecting Leveller Valve to water system ensure lines are flushed and free of debris.

Step 1a

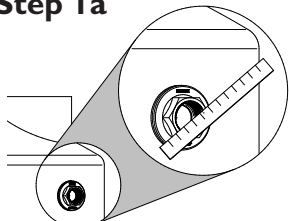

Measure the existing inlet thread to determine which size adaptor is required ie: 32mm, 40mm, 50mm.

Step 1b

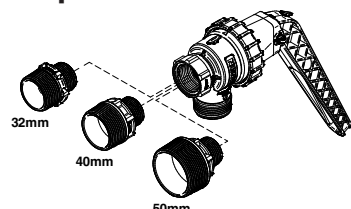

From the supplied adaptors choose the appropriate size.

Step 2a

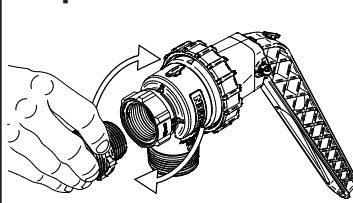

Screw selected adaptor into Leveller Valve Body (O-Ring facing to body)

Step 2b

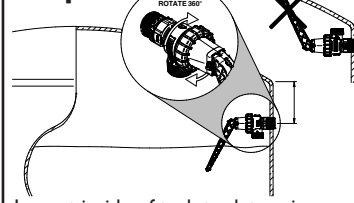

Inspect inside of tank to determine if there is enough clearance to install assembled valve. If yes, go to step 6. If not, go to step 3

Step 3a - Not Enough Clearance

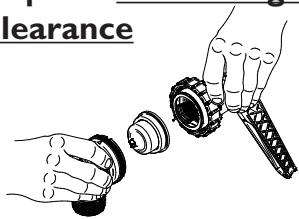

Remove the Leveller Valve Orange nut, arm assembly & rubber diaphragm from valve

Step 3b

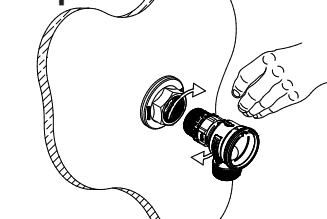

Screw Leveller Valve body into threaded inlet

Step 4a

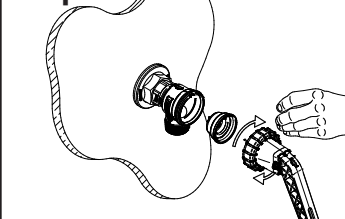

Re-assemble Leveller Valve, insert rubber diaphragm into valve body.

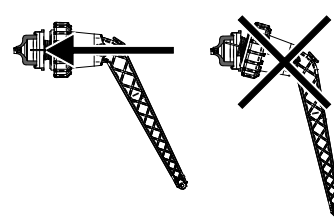

Guide Leveller Valve assembly into Leveller Valve body ensuring guide pin is in pilot hole. **Do Not Puncture Diaphragm!**

Step 5a

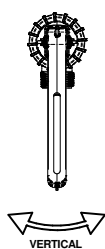

Ensure Leveller Arm is hanging down in a vertical position.

Step 5b

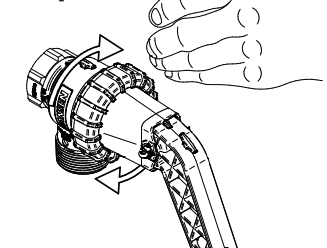

Tighten Orange Nut firmly!

Step 6

Decide on Minimum & Maximum water levels. See step 9 for minimum level guidance before proceeding through this step.

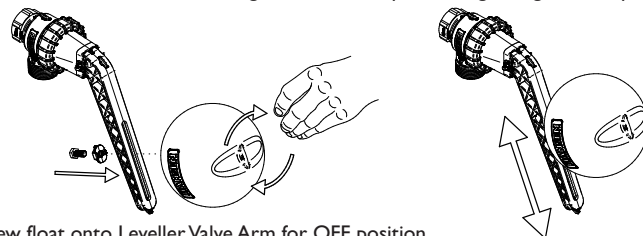

Screw float onto Leveller Valve Arm for OFF position. **This determines Maximum level of water.**

Step 7a

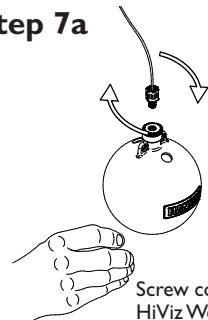

Screw cord nut into HiViz Weighted Ball.

Step 7b

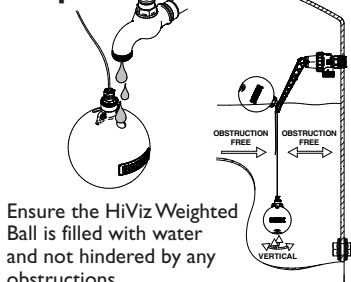

Ensure the HiViz Weighted Ball is filled with water and not hindered by any obstructions.

Step 8a

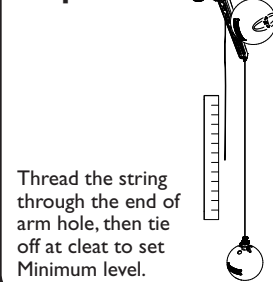

Thread the string through the end of arm hole, then tie off at cleat to set Minimum level.

Step 8b

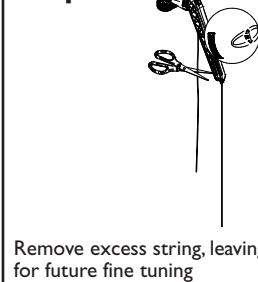

Remove excess string, leaving enough for future fine tuning

Step 9

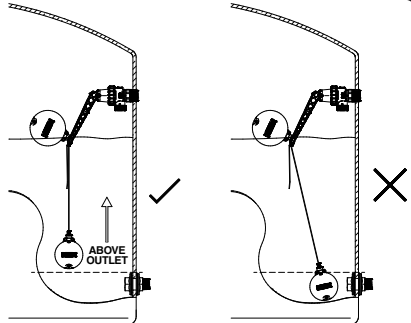

NOTE: The HiViz Weighted Ball must be off the bottom of the tank and most importantly above tank outlet.

Step 10a

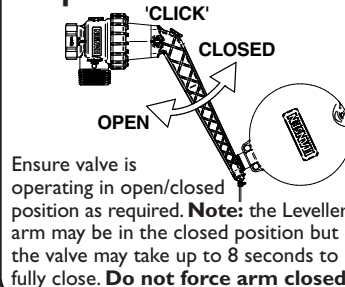

Ensure valve is operating in open/closed position as required. **Note:** the Leveller arm may be in the closed position but the valve may take up to 8 seconds to fully close. **Do not force arm closed.**

Step 10b

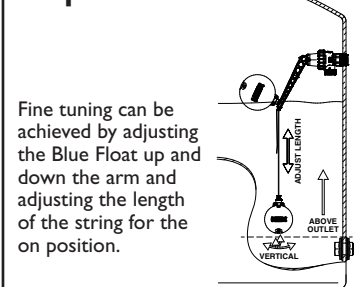

Fine tuning can be achieved by adjusting the Blue Float up and down the arm and adjusting the length of the string for the on position.