

TrueFit FEMALE TANK FITTING

HANSEN™

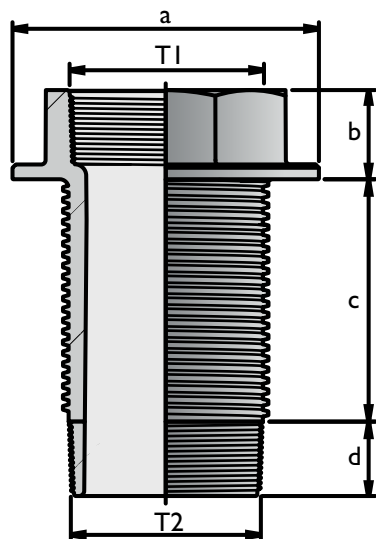

| Product Code | T1 BSPT | T2 BSPF | a mm | b mm | c mm | d mm |
|--------------|---------------|---------------|---------|---------|---------|---------|
| SFTFT15 | 1/2" (15mm) | 1/2" (15mm) | 56.9 | 20.0 | 97.0 | 8.0 |
| SFTFT20 | 3/4" (20mm) | 3/4" (20mm) | 63.4 | 21.0 | 96.0 | 9.0 |
| SFTFT25 | 1" (25mm) | 1" (25mm) | 73.0 | 24.0 | 95.0 | 10.0 |
| SFTFT32 | 1 1/4" (32mm) | 1 1/4" (32mm) | 83.6 | 25.8 | 93.0 | 12.0 |
| SFTFT40 | 1 1/2" (40mm) | 1 1/2" (40mm) | 92.0 | 26.7 | 93.0 | 12.0 |
| SFTFT50 | 2" (50mm) | 2" (50mm) | 105.2 | 30.7 | 90.0 | 15.0 |
| SFTFT80 | 3" (80mm) | 3" (80mm) | 140 | 40 | 110 | 34 |
| SFTFT100 | 4" (100mm) | 4" (100mm) | 166 | 47 | 112 | 41 |

FOR REFERENCE USE ONLY.
WITH OUR POLICY OF CONTINUING
PRODUCT DESIGN AND DEVELOPMENT,
SPECIFICATIONS, CODE NUMBERS
AND ITEMS ARE SUBJECT TO CHANGE
WITHOUT NOTICE.

© COPYRIGHT: HANSEN PRODUCTS (NZ) LIMITED.

RECOMMENDED HOLE SAW SIZES

SFTFT 15mm = 22mm or 7/8" Hole Saw
SFTFT 20mm = 27mm or 1 1/16" Hole Saw
SFTFT 25mm = 34mm or 1 3/8" Hole Saw
SFTFT 32mm = 42mm or 1 5/8" Hole Saw
SFTFT 40mm = 48mm or 1 7/8" Hole Saw
SFTFT 50mm = 60mm or 2 3/8" Hole Saw
SFTFT 80mm = 95mm or 3 3/4" Hole Saw
SFTFT 100mm = 121mm or 4 3/4" Hole Saw

MINIMUM RECOMMENDED HOLE SIZES

Hole Size for SFTFT 15mm = 22mm
Hole Size for SFTFT 20mm = 27mm
Hole Size for SFTFT 25mm = 34mm
Hole Size for SFTFT 32mm = 42mm
Hole Size for SFTFT 40mm = 48mm
Hole Size for SFTFT 50mm = 60mm
Hole Size for SFTFT 80mm = 95mm
Hole Size for SFTFT 100mm = 121mm